

Steel Tubing

For supply and feedlines.

Part No.	Size (O.D. x Wall)			Working Pressure	Type
	O.D. in.	Wall in.	Length ft. / m		
62175	1/8	.020	25 / 7.6	4400 psig / 300 bar	coil
62176	1/4	.028	25 / 7.6	2800 psig / 190 bar	coil
62249	3/8	.028	25 / 7.6	1850 psig / 126 bar	coil

Type 304 Stainless Steel Tubing

For supply and feedlines. For corrosive environments. ASTM A-269 specs.

Part No.	Size (O.D. x Wall)			Working Pressure	Type
	O.D. in.	Wall in.	Length ft. / m		
62948-9	1/8	.028	20/ 6.1	9000 psig / 612 bar	coil
62949-9	1/4	.028	20/ 6.1	4480 psig / 305 bar	coil
62950-9	3/8	.028	20/ 6.1	2980 psig / 203 bar	coil

Nylon Tubing

For feedlines. Temperature range -65°F to 150°F.

Part No.	Size (O.D. x Wall)			Working Pressure	Min. Bend Radius in.
	O.D. in.	Wall in.	Length ft. / m		
62256	1/8	.026	25 / 7.6	625 psig 42.5 bar	.375
62278			100 / 30.5		
62956			500 / 152		
62357	1/4	.050	100 / 30.5		.875
247022			500 / 152		

Single and Multiple Tube Clamps

For feedlines.

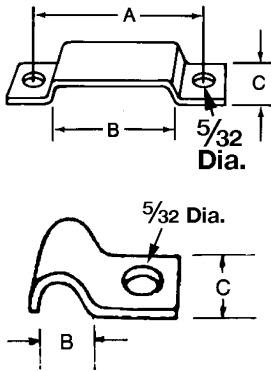

Clamp No.	Const.	No. Tubes	Tube Size in.	A in.	B in.	C in.	Screw No.	Screw Description	
64532-1	Steel	1	1/8 OD	—	1/8	3/8	66202	No. 6 roundhead 1/4" LG, Use No. 30 drill	
64532-2		2		1 1/16	1/4	3/8			
64532-3		3		1 3/16	3/8	3/8			
64532-4		4		1 5/16	1/2	3/8			
64532-5		5		1 1/8	5/8	3/8			
64533-1		1	1/4 OD	—	1/4	3/8			
64533-2				2	1 5/16	1/2			3/8
64533-3				3	1 3/16	3/4			3/8
64533-4				4	1 7/16	1			3/8
64533-5				5	1 1/8	1 1/4			3/8
69159-9	Type	1	1/8 OD	—	1/8	3/8	66202-9	No. 6 roundhead 1/4" LG, Use No. 30 drill	
69160-9	303	2		1 1/16	1/4	3/8			
69161-9	Stainless	3		1 3/16	3/8	3/8			
69163-9	Steel	5		1 1/8	5/8	3/8			

Single Tube Clamps

For supply lines.

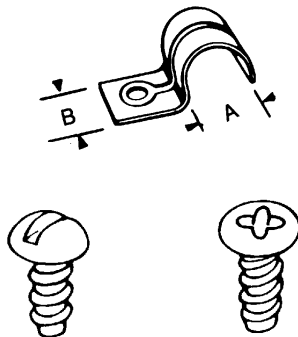

Clamp No.	Const.	Tube Size in.	A in.	B in.	Screw No.	Screw Description
360108	Steel	3/8 OD	3/8	1/2	66872	No. 10 round head, self-tapping 1/4" LG, use No. 17 drill
69164-9	Type 303	1/4 OD	1/4	3/8	66202-9	No. 6 round head, self-tapping 1/4" LG, use No. 30 drill
69165-9	Stainless Steel	3/8 OD	3/8	1/2	66872-9	No. 10 round head, self-tapping 1/4" LG, use No. 17 drill

Note: Screws listed in above tables. Order separately.

P Clamps

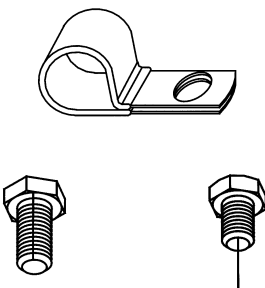

Clamp No.	Description	Material	Width in.	Length in.	Screw Description
249853	1 3/16" P style clamp	CRS	1	2 7/32	Use 249848 or 249849 bolts
249913	3/8" P style clamp	CRS	1		
270931	3/4" P style clamp	CRS	1	2 3/16	

Spring Coil

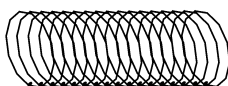

Clamp No.	Description	Material	Width in.	Screw Description
272598	25' spring coil	Steel	5/8" ID	Use 249848 or 249849 bolts

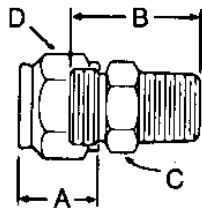

Heavy-Duty Tube Fittings—Male Connector

Tube to male pipe thread. For supply lines. Carbon steel unless noted (*) otherwise.

Part No.	Tube O.D. in.	Pipe Thread in.	A in.	B in.	Hex. C in.	Hex. D in.	Working Press. psig / bar
69068	1/4	1/8 NPT	19/32	61/64	1/2	5/8	5000 / 340
*69068-9	1/4	1/8 NPT	19/32	61/64	1/2	5/8	5000 / 340
69069	1/4	1/4 NPT	19/32	15/32	5/8	5/8	5000 / 340
*69069-9	1/4	1/4 NPT	19/32	15/32	5/8	5/8	5000 / 340
69070	3/8	1/8 NPT	3/4	1	5/8	3/4	5000 / 340
69071	3/8	1/4 NPT	3/4	1 13/64	5/8	3/4	5000 / 340
69072	3/8	3/8 NPT	3/4	1 13/64	3/4	3/4	5000 / 340

* 316 Stainless Steel

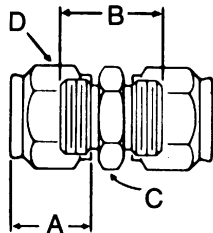

Heavy-Duty Tube Fittings—Union Connector

Tube to tube. For supply lines. Carbon steel unless noted (*) otherwise.

Part No.	Tube O.D. in.	A in.	B in.	Hex. C in.	Hex. D in.	Working Press. psig / bar
69078	3/8	3/4	1 1/16	5/8	3/4	6000 / 400

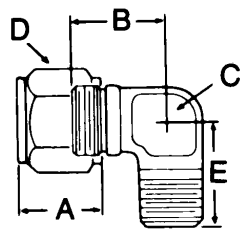

Heavy-Duty Tube Fittings—Male Elbow

Tube to male pipe thread. For supply lines. Carbon steel unless noted (*) otherwise.

Part No.	Tube O.D. in.	Pipe Thd. in.	A in.	B in.	Flats C in.	Hex. D in.	E in.	Working Press. psig / bar
*69079-9	1/4	1/8 NPT	19/32	3/4	7/16	5/8	25/32	5000 / 340
69080	1/4	1/4 NPT	19/32	7/8	9/16	5/8	1 1/16	5000 / 340
69082	3/8	1/4 NPT	3/4	59/64	9/16	3/4	1 3/32	5000 / 340
*69082-9	3/8	1/4 NPT	3/4	59/64	9/16	3/4	1 3/32	5000 / 340
69083	3/8	3/8 NPT	3/4	17/64	3/4	3/4	1 7/32	5000 / 340

* 316 Stainless Steel

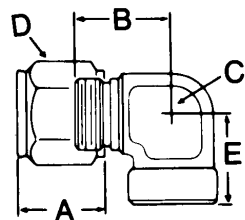

Heavy-Duty Tube Fittings—Female Elbow

Tube to female pipe thread. For supply lines. Carbon steel unless noted (*) otherwise.

Part No.	Tube O.D. in.	Pipe Thd. in.	A in.	B in.	Flats C in.	Hex. D in.	E in.	Working Press. psig / bar
69084	1/4	1/8 NPT	19/32	25/32	1/2	5/8	1 1/16	5000 / 340
*69085	1/4	1/4 NPT	19/32	1	3/4	5/8	7/8	5000 / 340

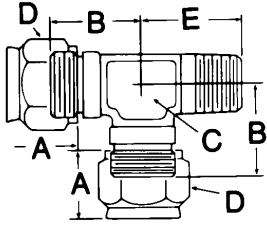

Heavy-Duty Tube Fittings—Male Run Tee

Tube to male pipe thread to tube. For supply lines. Carbon steel unless noted (*) otherwise.

Part No.	Tube O.D. in.	Pipe Thd. in.	A in.	B in.	Flats C in.	Hex. D in.	E in.	Working Press. psig / bar
69089	1/4	1/4 NPT	19/32	25/32	1/2	5/8	15/16	5000 / 340

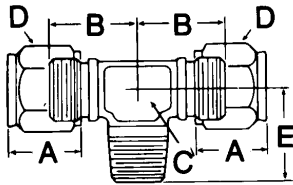

Heavy-Duty Tube Fittings—Male Branch Tee

Tube to tube to male pipe thread. For supply lines. Carbon steel unless noted (*) otherwise.

Part No.	Tube O.D. in.	Pipe Thd. in.	A in.	B in.	Flats C in.	Hex. D in.	E in.	Working Press. psig / bar
69093	3/8	1/4 NPT	3/4	63/64	5/8	3/4	1 1/16	5000 / 340

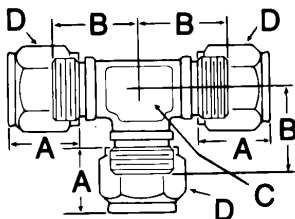

Heavy-Duty Tube Fittings—Union Tee

Tube to tube to tube. For supply lines. Carbon steel unless noted (*) otherwise.

Part No.	Tube O.D. in.	A in.	B in.	Flats C in.	Hex. D in.	Working Press. psig / bar
69094	1/4	19/32	3/4	7/16	5/8	5000 / 340
69095	3/8	3/4	63/64	5/8	3/4	5000 / 340

* 316 Stainless Steel

Heavy-Duty Tube Fittings—Sleeve

For supply lines. Carbon steel unless noted (*) otherwise.



Part No.	Tube O.D. - in.
69098	1/4
69099	3/8
*69099-9	3/8

* 316 Stainless Steel

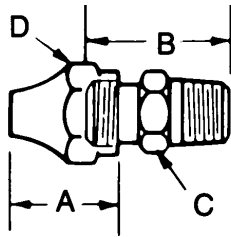

Standard-Duty Tube Fittings—Male Connector

Tube to male pipe thread. For supply and feed lines. Brass unless noted (*) otherwise.

Part No.	Tube O.D. in.	Pipe Thd. in.	A in.	B in.	Hex. C in.	Hex. D in.	Working Press. psig / bar
66200	1/4	1/8 NPT	3/4	7/8	7/16	9/16	2000 / 136
66211	1/4	1/4 NPT	3/4	1 1/16	9/16	9/16	2000 / 136
68415	3/8	1/8 NPT	7/8	31/32	9/16	11/16	2000 / 136
66846	3/8	1/4 NPT	7/8	1 5/32	9/16	11/16	2000 / 136
*69169-9	1/8	1/8 NPT	33/64	27/32	7/16	1/2	2000 / 136

* 316 Stainless Steel

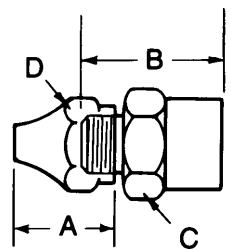

Standard-Duty Tube Fittings—Female Connector

Tube to female pipe thread. For supply and feed lines. Brass unless noted (*) otherwise.

Part No.	Tube O.D. in.	Pipe Thd. in.	A in.	B in.	Hex. C in.	Hex. D in.	Working Press. psig / bar
68943	1/4	1/8 NPT	3/4	25/32	9/16	9/16	2000 / 136

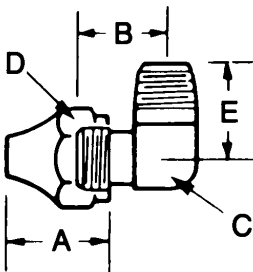

Standard-Duty Tube Fittings—Male Elbow

Tube to male pipe thread. For supply and feed lines. Brass unless noted (*) otherwise.

Part No.	Tube O.D. in.	Pipe Thd. in.	A in.	B in.	Flats C in.	Hex. D in.	E in.	Working Press. psig / bar
66201	1/4	1/8 NPT	3/4	19/32	7/16	9/16	23/32	2000 / 136
66210	1/4	1/4 NPT	3/4	5/8	9/16	9/16	3/4	2000 / 136
68412	3/8	1/8 NPT	7/8	11/16	9/16	11/16	11/16	2000 / 136
66762	3/8	1/4 NPT	7/8	23/32	9/16	11/16	29/32	2000 / 136
68414	3/8	3/8 NPT	7/8	27/32	11/16	11/16	31/32	2000 / 136
*69166-9	1/8	1/8 NPT	33/64	21/32	7/16	1/2	3/4	2000 / 136

* 316 Stainless Steel

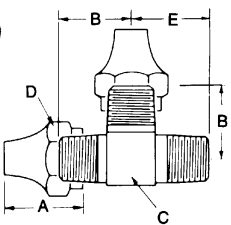

Standard-Duty Tube Fittings—Male Run Tee

For supply and feed lines. Brass unless noted (*) otherwise. Tube to male pipe thread to tube.

Part No.	Tube O.D. in.	Pipe Thd. in.	A in.	B in.	Flats C in.	Hex. D in.	E in.	Working Press. psig / bar
68615	1/4	1/8 NPTF	3/4	21/32	7/16	9/16	23/32	2000 / 136

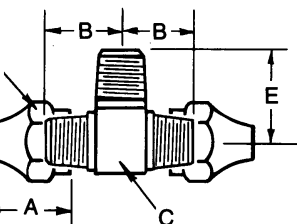

Standard-Duty Tube Fittings—Male Branch Tee

Tube to tube to male pipe thread. For supply and feed lines. Brass unless noted (*) otherwise.

Part No.	Tube O.D. in.	Pipe Thd. in.	A in.	B in.	Flats C in.	Hex. D in.	E in.	Working Press. psig / bar
66651	1/4	1/8 NPTF	3/4	21/32	7/16	9/16	23/32	2000 / 136
66876	3/8	1/4 NPTF	7/8	25/32	9/16	11/16	29/32	2000 / 136

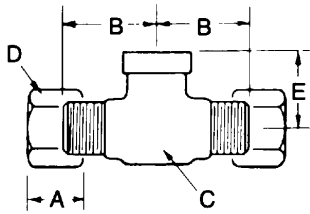

Standard-Duty Tube Fittings—Female Branch Tee

Tube to tube to female pipe thread. For supply and feed lines. Brass unless noted (*) otherwise.

Part No.	Tube O.D. in.	Pipe Thd. in.	A in.	B in.	Flats C in.	Hex. D in.	E in.	Working Press. psig / bar
67374	3/8	1/4 NPTF	3/4	1 1/16	3/4	1 1/16	7/8	2000 / 136

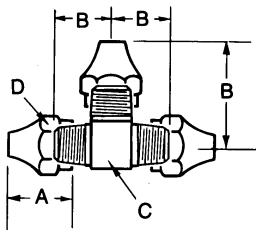

Standard-Duty Tube Fittings—Union Tee

Tube to tube to tube. For supply and feed lines. Brass unless noted (*) otherwise.

Part No.	Tube O.D. in.	A in.	B in.	C in.	Hex. D in.	Working Press. psig / bar
66650	1/4	3/4	5/8	7/16	9/16	2000 / 136
66878	3/8	7/8	23/32	9/16	1 1/16	2000 / 136

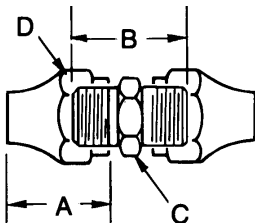

Standard-Duty Tube Fittings—Union

Tube to tube. For supply and feed lines. Brass unless noted (*) otherwise.

Part No.	Tube O.D. in.	A in.	B in.	Hex C in.	Hex. D in.	Working Press. psig / bar
68468	1/4	3/4	25/32	7/16	9/16	2000 / 136

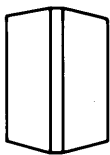

Standard-Duty Tube Fittings—Sleeve

For supply and feed lines. Carbon steel unless noted (*) otherwise. Included with all standard duty fittings.

Part No.	Tube O.D. - in.
68462	1/4
68463	3/8
*69170-9	1/8

* 316 Stainless Steel

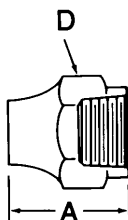

Standard-Duty Tube Fittings—Nut

For supply and feed lines. Carbon steel unless noted (*) otherwise. Included with all standard duty fittings.

Part No.	Tube O.D. in.	A in.	Hex D in.
68464	1/4	3/4	9/16
68465	3/8	7/8	1 1/16
*69171-9	1/8	33/64	1/2

* 316 Stainless Steel

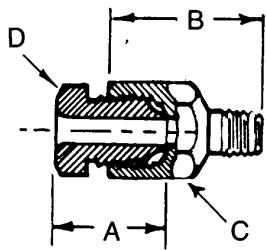

Threaded Sleeve Tube Fittings—Straight

Tube to male thread. For feed lines. Carbon steel with brass nut unless noted (*) otherwise.

Part No.	Tube O.D. in.	Thread in.	A in.	B in.	Hex. C in.	Hex. D in.	Working Press. psig / bar
66771	1/8	10-32	1/2	1 1/16	3/8	5/16	500 / 34
66714	1/8	1/4 -28	1/2	5/8	3/8	5/16	500 / 34
*66714-9	1/8	1/4 -28	1/2	5/8	3/8	5/16	500 / 34
66772	1/8	1/4 -28	1/2	1 1/16	3/8	5/16	500 / 34
66730	1/8	5/16 -32	1/2	1 1/16	3/8	5/16	500 / 34
66773	1/8	3/8 -24	1/2	1 1/16	7/16	5/16	500 / 34
**66415	1/8	1/8 NPTF	1/2	5/8	7/16	5/16	500 / 34

* 303 Stainless Steel ** Brass

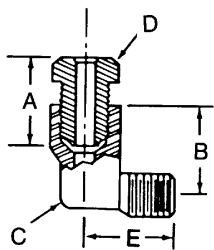

Threaded Sleeve Tube Fittings—90° Elbow

Tube to male thread. For feed lines. Brass with brass nut unless noted (*) otherwise.

Part No.	Tube O.D. in.	Thread in.	A in.	B in.	Flats C in.	Hex. D in.	E in.	Working Press. psig / bar
66716	1/8	1/4 -28	1/2	1/2	13/32	5/16	33/64	500 / 34
66414	1/8	1/8 NPTF	1/2	1/2	7/16	5/16	21/32	500 / 34

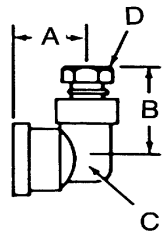

Threaded Sleeve Tube Fittings—90° Elbow

Tube to female pipe thread. For feed lines. Brass with brass nut unless noted (*) otherwise.

Part No.	Tube O.D. in.	Pipe Thread in.	A in.	B in.	Flats C in.	Hex. D in.	Working Press. psig / bar
66935	1/8	1/8 NPT	23/32	1 1/32	3/8	5/16	500 / 34

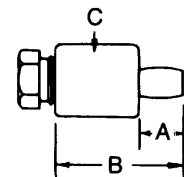

Threaded Sleeve Tube Fittings—Drive-Type

For feed lines. Steel body with brass nut.

Part No.	Hole Size in.	Tube O.D. in.	A in.	B in.	Dia. C in.	Hex. D in.	Working Press. psig / bar
82092	3/16	1/8	13/64	45/64	7/16	5/16	500 / 34

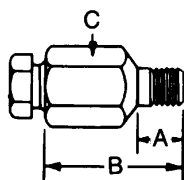

Threaded Sleeve Tube Fittings—Spin Drive Type

For feed lines. Steel body with brass nut.

Part No.	Hole Size in.	Tube O.D. in.	A in.	B in.	Hex C in.	Hex. D in.	Working Press. psig / bar
82093	1/4	1/8	5/32	5/8	7/16	5/16	500 / 34

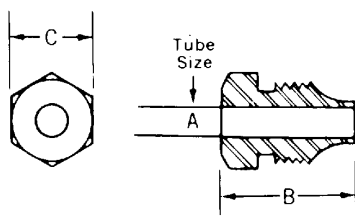

Threaded Sleeve Tube Fittings—Compression Nuts

For feed lines. Brass unless noted (*) otherwise.

Part No.	A Tube Size O.D. in.	B in.	C in.	Working Press. psig / bar
66260	1/8	1/2	5/16	500 / 34
*66260-9	1/8	1/2	5/16	500 / 34
66713	1/4	5/8	7/16	500 / 34

Installation Components

Tube Fittings—Snap-on Couplers

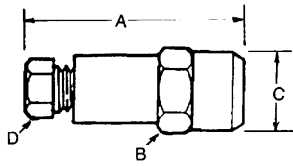

Snap-on Coupler Tube Fittings—Straight

Connect tubing to existing hydraulic (grease) fittings. Aluminum body, brass nut, Buna N packing.

Part No.	Tube O.D. Size - in.	A in.	B Hex in.	C in.	D Hex in.	Working Pressure
*82617	1/8	1.18	7/16	.43	1/4	500 psi
**241389	1/4	1.69	5/8	.43	7/16	34 bar

* Uses Model 13112 compression nut (included). **Uses 66713 compression nut (included).

Note: Coupling to grease fitting is a permanent connection.

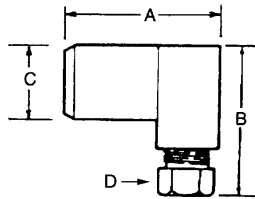

Snap-on Coupler Tube Fittings—90° Elbow

Connect tubing to existing hydraulic (grease) fittings. Aluminum body, brass nut, Buna N packing.

Part No.	Tube O.D. Size - in.	A in.	B Hex in.	C in.	D Hex in.	Working Pressure
*82618	1/8	.83	.86	.43	1/4	500 psi
**241388	1/4	1.03	1.18	.43	7/16	34 bar

* Uses Model 13112 compression nut (included). **Uses 66713 compression nut (included).

Note: Coupling to grease fitting is a permanent connection.

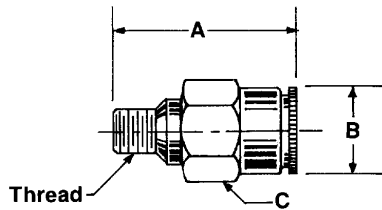

Quicklinc™ Tubing Adapter – Male Straight

Use with 1/4" O.D. non-metallic tube for quick installation. Tubing simply pushes into place without ferrules or flairs. Nickel plated brass construction.

Part No.	Tube O.D. Size - in.	Thread	Dimensions - Inches / mm			Max. Operating Pressure
			A	B	C-Hex	
244047	1/4	1/8" NPTF	.984 / 25	.460 / 11.7	.472 / 12	250 psig / 17 bar
244055		1/4-28	.784 / 19.9			
244057		M6X1-6G Tapered	.965 / 24.5			

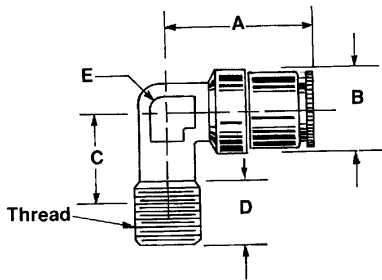

Quicklinc™ Tubing Adapter – Male 90° Elbow, Non-Swivel

Use with 1/4" O.D. non-metallic tube for quick installation. Tubing simply pushes into place without ferrules or flairs. Nickel plated brass construction.

Part No.	Tube O.D. Size - in.	Thread	Dimensions - Inches / mm					Max. Oper. Pressure
			A	B	C	D	E-Flat	
244048	1/4	1/8" NPTF	.905 23	.500 12.7	.531 / 13.5	.374 / 9.5	.394 10	250 psig 17 bar
244054		1/4-28				.172 / 4.4		
244056		M6X1-6G Tapered				.590 / 15		

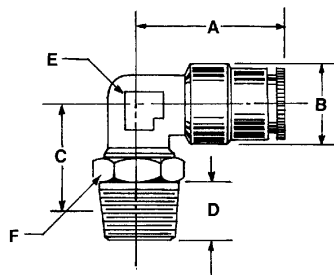

Quicklinc™ Tubing Adapter – Male 90° Elbow, Swivel

Use with 1/4" O.D. non-metallic tube for quick installation. Tubing simply pushes into place without ferrules or flairs. Nickel plated brass construction.

Part No.	Tube O.D. Size - in.	Thread	Dimensions - Inches / mm						Max. Oper. Pressure
			A	B	C	D	E-Flat	F-Hex	
243699	1/4	1/8" NPTF	.905 23	.500 12.7	.728 18.5	.374 9.5	.354 9	.472 12	250 psig 17 bar
244053		1/4-28							

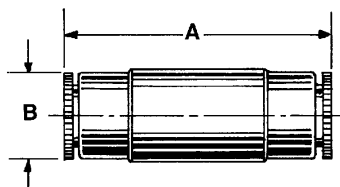

Quicklinc™ Tubing Adapter – Tube Union

Use with 1/4" O.D. non-metallic tube for quick installation. Tubing simply pushes into place without ferrules or flairs. Nickel plated brass construction.

Part No.	Tube O.D. Size - in.	Dimensions - Inches / mm		Max. Oper. Pressure
		A	B	
244058	1/4	1.397 / 35.5	.460 / 11.7	250 psig / 17 bar

Supply Line and Material Hose

Type	I.D. in.	Wire Braid	Working Pressure	Min. Burst Pressure	Fittings in.	Min. Bend radius in.	Part No.	Length	
								in.	cm
75 High Pressure	¼	Double	5000 psig 340 bar	20000 psig 1360 bar	½ -27 female	4	75024	24	61
							75060	60	152.4
							75084	84	213
							75120	120	305
							75168	168	427
							75240	240	610
							75360	360	915
							75480	480	1220
75600	600	1525							
759 High Pressure	⅜	Double	4500 psig 306 bar	20000 psig 1360 bar	⅛ NPT male	2½	75948	48	122
							75960	60	152
76B High Pressure	⅜	Double	4000 psig 272 bar	16000 psig 1088 bar	½ NPT female	5	76024B	24	61
							76600B	600	1525
							76900B	900	2288
76A High Pressure	½	Double	3500 psig 238 bar	14000 psig 952 bar	½ NPT female	7	76024A	24	61
							76600A	600	1525
79 Volume Med. Pressure	⅜	Single	2250 psig 153 bar	9000 psig 612 bar	¾ NPT male	5	79060	60	152.4
73 Med. Pressure	½	Single	1000 psig 68 bar	4000 psig 272 bar	½ NPT male		73024	24	61
							73036	36	91.4
							73060	60	152.4
							73120	120	305
							73240	240	610
							73360	360	915
							73480	480	1220
							73600	600	1525
73900	900	2288							
78 Volume Med. Pressure	⅝	Single	1500 psig 102 bar	6000 psig 408 bar	½ NPT male		78024	24	61
							78600	600	1525
1230 Med. Pressure	¾	Double	2250 psig 153 bar	9000 psig 612 bar	¾ NPT male		1230120	120	305

Note: Refer to Design Guides for the correct hose for your system.

Feed Line Hose (SAE 30R-3 Type)

For flexible connections between lube outlets, anchor blocks, swivels, tube connectors and bearings. Hose is $\frac{3}{16}$ " I.D. x $\frac{3}{8}$ " O.D.

Series 71900

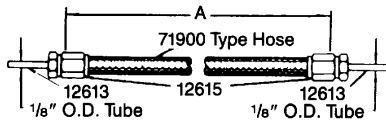

Part No.	Connections in.	Working Pressure	Min. Bend Radius in.	Length "A"	
				in.	cm
71908	$\frac{1}{8}$ O.D. tube	500 psig 34 bar	2	8	20.3
71912	x			12	30.5
71918	$\frac{1}{8}$ O.D. tube			18	45.7

Series 82238

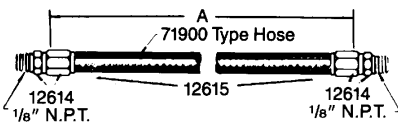

Part No.	Connections in.	Working Pressure	Min. Bend Radius in.	Length "A"	
				in.	cm
82238-12	$\frac{1}{8}$ NPTF (M)	500 psig 34 bar	2	12	30.5
82238-18	x			18	45.7
82238-24	$\frac{1}{8}$ O.D. tube			24	61

Series 81712

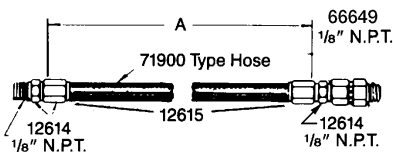

Part No.	Connections in.	Working Pressure	Min. Bend Radius in.	Length "A"	
				in.	cm
81712-6	$\frac{1}{8}$ NPTF (M)	500 psi 34 bar	2	6	15.2
81712-8	x			8	20.3
81712-18	#66649			18	45.7
81712-24	Adapter Union			24	61
81712-30	$\frac{1}{8}$ NPTF (M)			30	76.2
81712-36				36	91.4

Series 82239

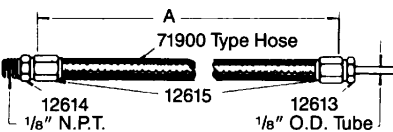

Part No.	Connections in.	Working Pressure	Min. Bend Radius in.	Length "A"	
				in.	cm
82239-12	$\frac{1}{8}$ O.D. tube	500 psig 34 bar	2	12	30.5
82239-18	x			18	45.7
82239-24	$\frac{1}{8}$ NPTF (M)			24	61

Bulk Feed Line Hose and Fittings

Cut to required length and install connector fittings with standard wrenches.
SAE 30R3 type hose. Temperature range -40°F to 212°F.

Bulk Type 71900 Hose

Part No.	Size		Working Pressure	Min. Bend Radius in.	Length ft. / m
	I.D. in.	O.D. in.			
66844 71900	3/16	3/8	500 psig / 34 bar	2	25 / 7.6 Specify length

Fittings for 71900 Hose

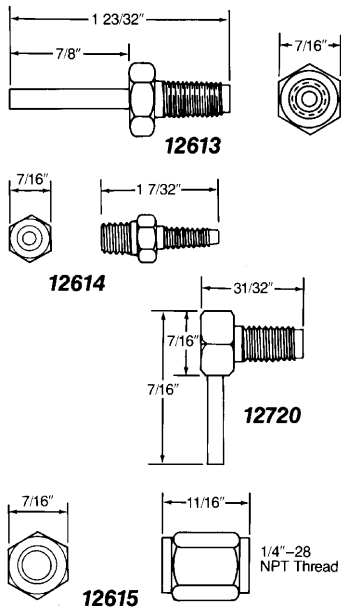

Part No.	Construction	Description	Size - in.
12613	Steel	Hose Stud	1/8 O.D. tube x 1/4 -28 male
12614			1/8 NPT male x 1/4 -28 male
13003			1/4 -28 male x 1/4 -28 male
12720			1/8 O.D. tube x 1/4 -28 male, 90° angle
12615*		Coupling Nut	1/4 -28 female
12613-9	Type 303 Stainless Steel	Hose Stud	1/8 O.D. tube x 1/4 -28 male
12614-9			1/8 NPT male x 1/4 -28 male
12615-9*			Coupling Nut

* One coupling nut required for each hose stud.

Air Hose

Connect system to compressed air supply.

Part No.	Length ft.	Specifications			Maximum Pressure		Braid
		I.D. in.	O.D. in.	Thread in.	Working	Burst	
72024 72036 72060 72120 72240 72480 72600	2 3 5 10 20 40 50	1/4	5/8	1/4 NPT male	250 psig 17 bar	1250 psig 85 bar	2-Ply Rayon
72024A 72360A 72480A 72600A 72720A	2 30 40 50 60	3/8	27/32	3/8 NPT male	250 psig 17 bar	1250 psig 85 bar	2-Ply Rayon
74024 74060 74480 74600	2 5 40 50	1/2	27/32	1/2 NPT male	200 psig 14 bar	800 psig 55 bar	1-Ply Rayon



Heavy-Duty Air Line Quick Disconnects

Rugged, high flow industrial design steel couplers and nipples.

For 3/8" I.D. Hose			
Part	Description	Size	Max. Air Pressure
645006	Coupler	3/8" NPT F	300 psig / 20 bar
For 1/2" I.D. Hose			
Part	Description	Size	Max. Air Pressure
655008	Coupler	1/2" NPT F	300 psig 20 bar
655012	Coupler	3/4" NPT F	
653112	Nipple	3/4" NPT M	
For 3/4" I.D. Hose			
Part	Description	Size	Max. Air Pressure
662012	Coupler	3/4" NPT F	300 psig 20 bar
660112	Nipple	3/4" NPT M	

Pipe Fittings—Reducing Bushings

For supply and feed lines.

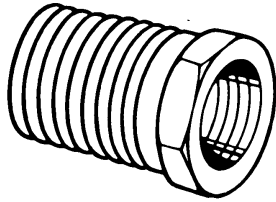

Part No.	Thread / in.	Construction
10461	1/8 NPTF female x 1/4 NPTF male	Steel
10200	1/8 NPTF female x 1/2-27 NPTF male	Brass
11229	1/4 NPTF female x 1/8 NPTF male	Steel
11348	1/4 NPTF female x 1/4 NPTF male	Steel
20011	1/4 NPTF female x 3/8 NPTF male	Steel
12080	1/4 NPTF female x 1/2 NPTF male	Steel
10204	1/4 NPTF female x 1/2-27 NPTF male	Brass
10049	3/8 NPTF female x 1/4 NPTF male	Steel
67069	3/8 NPTF female x 1/2 NPTF male	Steel
67198	3/8 NPTF female x 3/4 NPTF male	Steel
12989	1/2 NPTF female x 1/4 NPTF male	Steel
67171	1/2 NPTF female x 3/4 NPTF male	Steel
12287	1/2-27 NPTF female x 1/2 NPTF male	Steel

Pipe Fittings—Nipples

For supply and feed lines.

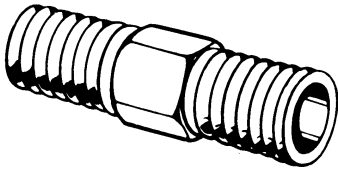

Part No.	Thread / in.	Style	Construction
10130	1/8 NPTF male x 1/8 NPTF male	Hex	Steel
67371	1/8 NPTF male x 1/8 NPTF male	Close	Brass
10772	1/8 NPTF male x 1/4 NPTF male	Hex	Steel
10199	1/8 NPTF male x 1/2-27 NPTF male	Hex	Brass
10462	1/4 NPTF male x 1/4 NPTF male	Hex	Steel
10462-9	1/4 NPTF male x 1/4 NPTF male	Hex	Stainless Steel-303
10198	1/4 NPTF male x 1/2-27 NPTF male	Hex	Brass
10773	3/8 NPTF male x 1/4 NPTF male	Hex	Steel
14727	3/4 NPTF male x 1/4 NPTF male	Hex	Steel
10540	3/8 NPTF male x 1/2 NPTF male	Hex	Steel
11107	3/8 NPTF male x 3/4 NPTF male	Hex	Steel
11197	1/2-27 NPTF male x 1/2 NPTF male	Hex	Steel
12957	1/2 NPTF male x 1/2-27 NPTF male	Hex	Steel
12106	1/2 NPTF male x 1/4 NPTF male	Hex	Steel
10202	1/2-27 NPTF male x 1/2-27 NPTF male	Hex	Brass

Pipe Fittings—Couplings

For supply and feed lines.

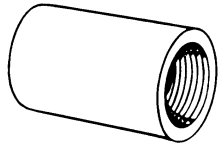

Part No.	Thread / in.	Construction
67063	1/8 NPTF female x 1/8 NPTF female	Steel
67360	1/8 NPTF female x 1/8 NPTF female	Brass
67179	1/2 NPTF female x 1/2 NPTF female	Forged Steel

Pipe Fittings—Reducing Couplings

For supply and feed lines.

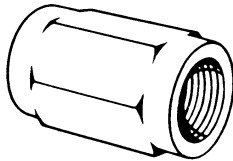

Part No.	Thread / in.	Construction
11852	1/8 NPTF female x 1/2-27 NPTF female	Steel
67094	1/4 NPTF female x 3/8 NPTF female	Malleable Iron
67176	1/4 NPTF female x 1/2 NPTF female	Forged Steel
10522	1/4 NPTF female x 1/2-27 NPTF female	Brass
67296	3/8 NPTF female x 1/2 NPTF female	Forged Steel

Pipe Fittings—Street Ells

For supply and feed lines.

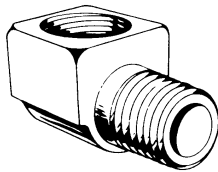

Part No.	Thread / in.	Construction
67368	1/8 NPTF female x 1/8 NPTF male	Brass
67368-9	1/8 NPTF female x 1/8 NPTF male	Stainless Steel-304
67054	1/4 NPTF female x 1/4 NPTF male	Brass
67358	3/8 NPTF female x 3/8 NPTF male	Brass
67074	1/2 NPTF female x 1/2 NPTF male	Malleable Iron
67062	3/4 NPTF female x 3/4 NPTF male	Malleable Iron

Pipe Fittings—Tees

For supply and feed lines.

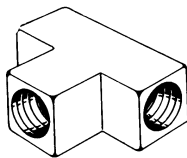

Part No.	Thread / in.	Construction
67011	1/8 NPTF female x 1/8 NPTF female	Brass
67102	1/4 NPTF female x 1/4 NPTF female	Brass
67102-9	1/4 NPTF female x 1/4 NPTF female	Stainless Steel-304
243373	1/2 NPTF female x 1/2 NPTF female	Forged Steel

Street Tee

Part No.	Description
67448	1/8" NPT male x 1/8" NPT female x 1/8" NPT female

Pipe Fittings—Crosses

For supply and feed lines.

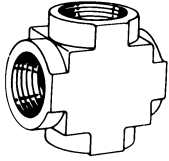

Part No.	Thread / in.	Construction
----------	--------------	--------------

Pipe Fittings—Adapter Unions

For supply and feed lines.

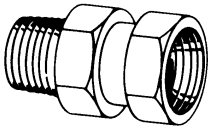

Part No.	Thread / in.	Construction
66649	1/8 NPSM* female swivel x 1/8 NPTF male	Steel
66645	1/4 NPSM* female swivel x 1/4 NPTF male	Steel
66842	3/8 NPSM* female swivel x 3/8 NPTF male	Steel
66883	1/2 NPSM* female swivel x 1/2 NPTF male	Steel
69375	1 NPTF female swivel x 1 NPTF male	Steel

Pipe Fittings—Elbows

For supply and feed lines.

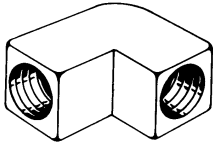

Part No.	Thread / in.	Construction
67103-9	1/4 NPTF female x 1/4 NPTF female	Stainless Steel-304

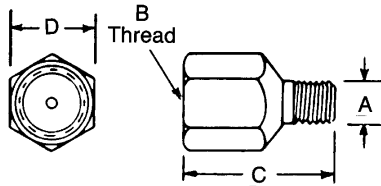

Pipe Fittings—Straight Adapters

For supply and feed lines. Carbon steel.

Part No.	A in.	B in.	C in.	D in.
20024	1/4-28	1/8 NPSF	7/8	1/2
66648	5/16-24	1/8 NPTF	31/32	9/16

Metric

Part No.	A in.	B in.	C in.	D in.
103307E	M6 x 1	1/4-28	.56	.393/.472*
103308E	M8 x 1			
103309E	M10 x 1			

* Hex material may vary.

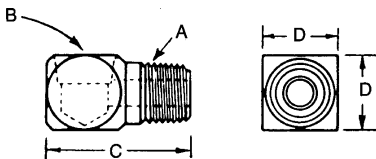

Pipe Fittings—90° Adapters

For supply and feed lines. Carbon Steel.

Part No.	A in.	B in.	C in.	D in.
20026	1/4-28	1/8 *	13/16	1/2
20029	1/8 *	1/8 **	1	1/2
20031	1/8 *	1/8 *	13/16	1/2
20012	1/4 *	1/4 NPTF	15/16	11/16

* PTF special extra short. ** SAE short.

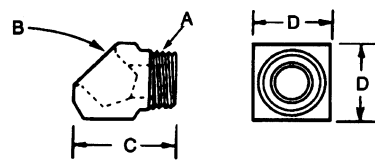

Pipe Fittings—45° Adapters

For supply and feed lines. Carbon Steel.

Part No.	A in.	B in.	C in.	D in.
20028	1/8 **	1/8 **	1	1/2
247616	1/4-28	1/8 *	11/16	1/2

* PTF special extra short. ** SAE short.

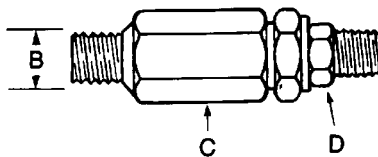

Supply Line Swivels—Straight Swivels (one swivel section)

For lubricant supply lines. Swivels have steel bodies and nitrile packing.

Part No.	A (in.)	B (in.)	C (in.)	D (in.)	Working Pressure
82080	1/2-27	1/2-27	7/8	9/16	5,000 psig 340 bar
83938	1/4 NPTF	1/4 NPTF	7/8	9/16	
81728	3/8 NPTF	1/2 NPTF	1 1/4	1 1/16	
82072	1/2 NPTF	1/2 NPTF	1 1/4	7/8	

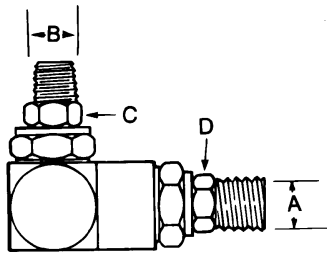

Supply Line Swivels—90° Angle Swivels (one swivel section)

For lubricant supply lines. Swivels have steel bodies and nitrile packing.

Part No.	A in.	B in.	C in.	D in.	Working Pressure
81386	1/8 NPTF	1/2-27	9/16	7/16	5,000 psig 340 bar
81723	1/8 NPTF	1/8 NPTF	5/8	7/16	
81974	1/2-27	1/4 NPTF	9/16	9/16	
82251	1/8 NPTF	1/8 NPTF	7/16	7/16	
82087	1/2 NPTF	1/2 NPTF	7/8	7/8	

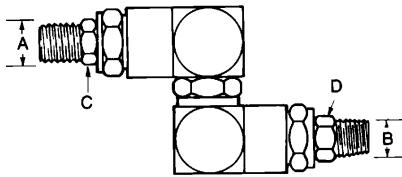

Supply Line Swivels—Universal Swivels (three swivel sections)

For lubricant supply lines. Swivels have steel bodies and nitrile packing.

Part No.	A in.	B in.	C in.	D in.	Working Pressure
82252	1/8 NPTF	1/8 NPTF	7/16	7/16	5,000 psig 340 bar
81387	1/4 NPTF	1/2-27	9/16	9/16	
83594	1/4 NPTF	1/4 NPTF	9/16	9/16	
81729	1/2 NPTF	3/8 NPTF	7/8	1 1/16	
82073	1/2 NPTF	1/2 NPTF	7/8	7/8	

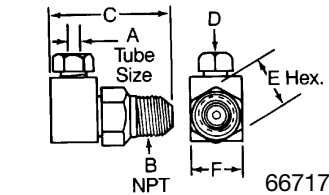

66717

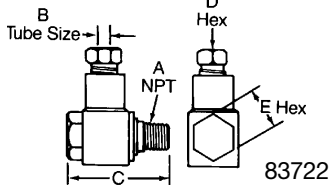

83722

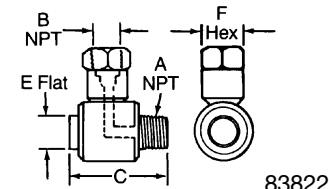

83822

Feed Line Swivels—90° Angle Swivels

For lubricant feed lines. All models have a single swivel section and Buna N seals unless noted otherwise.

Part No.	A Inlet in.	B Outlet in.	C Length in.	D Hex in.	E Hex/Flat in.	F Flat in.
66717	1/8 O.D.	1/8	1 1/4	5/16	9/16	1/2
*66717-9	Tube	NPTF (M)				
91048	1/8	1/8	1 1/4	N/A	9/16	1/2
*91048-9	NPTF (F)	NPTF (M)				
*83722	1/8 O.D. Tube	1/4 -28	1 5/16	1 5/16	3/8	
83822	1/8 NPTF (F)	1/8 NPTF (F)	1 3/8	1/2	3/8	

* 303 Stainless Steel

Note: Models 91048 & 91048-9 are similar in appearance to 66717 & 66717-9, but do not include direct tube connections.

Feed Line Swivels—Straight Swivels

For lubricant feed lines. All models have a single swivel section and Buna N seals unless noted otherwise.

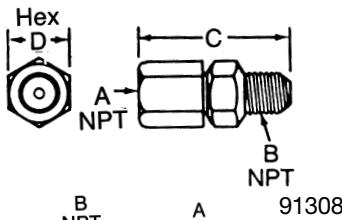

91308

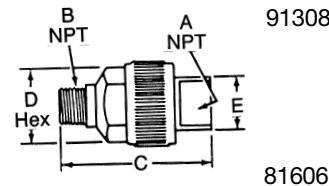

81606

Part No.	A Thread in.	B Thread in.	C Length in.	D Hex in.	E Flat in.
91308	1/8	1/8	1 3/8	9/16	
*92131	NPTF (F)	NPTF (M)			
81606	1/8 NPTF (F)	1/8 NPT (M)	1 1/2	3/4	15/32

* With Viton® seals.

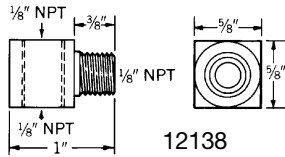

12138

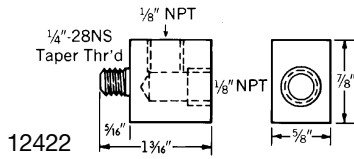

12422

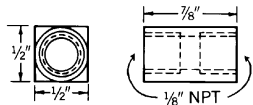

12612

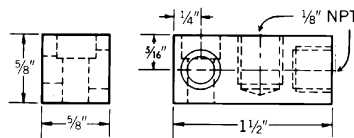

81583

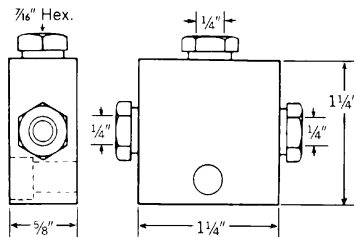

82225

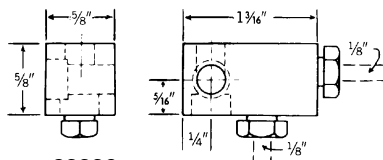

82226



249520

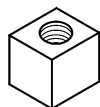

270928



249851



249850

Anchor and Junction Blocks

Securely fasten flexible supply and feed lines.

Part No.	Description	Use with Series Injectors*	Installation Method
12138	Anchor Block	SL-1, 11, 32, 33, 41, 42, 43, 44	Use 1/2" drill and 1/8" NPT tap
12422		SL-1, 11, 32, 33, 41, 42, 43, 44	Use No. 3 drill and 1/4 -28 tap
81583**		SL-1, 11, 32, 33, 41, 42, 43, 44	Use No. 7 drill and 1/4 -20 tap
82226**		SL-32, 33, 42, 43	Use No. 7 drill and 1/4 -20 tap
82225**	Junction Block	SL-32, 33, 42, 43	Use No. 7 drill and 1/4 -20 tap

* Can also be used with corresponding size supply and feed lines on Modular Lube II and Quicklub systems.

** Includes 50521 mounting screw.

Pump Mounting Bracket and Hardware for 203 Series and QLS 300 & 400 Series Pumps

Part No.	Description
249520	Pump mounting bracket for 203/301/401 Series pumps
249209	12 mm x 1 1/2" long grade 8 bolt for pump bracket

Stand Offs for Mounting SSV Valves, P-Clamps and Angle Iron

Part No.	Description
252807	Divider valve mounting block
249987	6mm bolt to be used with the 252807
249850	12mm round stand off
270928	12mm square stand off
249848	12mm x 5/8" long bolt to be used with 249850 and 270928
249851	10mm round stand off



Modular Air Line Filters

Part No.	Maximum Air Supply	Operating Temperature Range	Material of Construction		Element	
			Body	Bowl	Material	Particle Size
602104	250 psig 17 bar	0° to 150°F	Zinc	Zinc*	Sintered	40µ
602106		-18° to 65°C	Aluminum	Aluminum*	Polypropylene	
602108		0° to 175°F				
602109		-18° to 79°C				

* Transparent nylon liquid level indicator lens.

Part No.	Drain Type	Port Size PTF	Dimensions - in. / mm				Weight lbs. / kg
			A	B	C	Dia.	
602104	Manual	¼	5.27	0.75	1.98	1.91	1.1
602106		⅜	134	19	50	48	0.5
602108		½	6.95 / 177	1.00	3.15	2.89	1.8
602109	Automatic		6.35 / 161	25	80	74	0.8



Modular Air Line Regulators

Part No.	Maximum Air Supply	Operating Temperature Range	Material of Construction				Secondary (Gauge) Connections (in.)
			Body	Bonnet	Valve Seals	Bottom Plug	
602004	300 psig 20 bar	0° to 150°F -18° to 65°C	Zinc	Acetal	Brass Nitrile	Acetal	½ NPT (F)
602005							
602006		0° to 175°F -18° to 79°C	Aluminum	Aluminum			¼ NPT (F)
602007							
602008							
602009							

Part No.	Outlet Pressure Adj. Range	Connections NPT-Female (in.)	Dimensions - in. / mm				Adjuster	Weight lbs. / kg	
			A	B	C	D			
602004	5 to 150 psig	¼	4.0 / 102	1.31	2.0	3.2	T-Handle	0.8	
602005			2.88 / 73				Knob		
602006	0.3 to 4 bar	⅜	4.0 / 102	33	50	83	T-Handle		0.4
602007			2.88 / 73				Knob		
602008	10 to 250 psig 0.7 to 16 bar	½	5.95	1.69	3.15	5.1	T-Handle	1.77	
602009	5 to 150 psig 0.3 to 4 bar		151 5.0				43		80

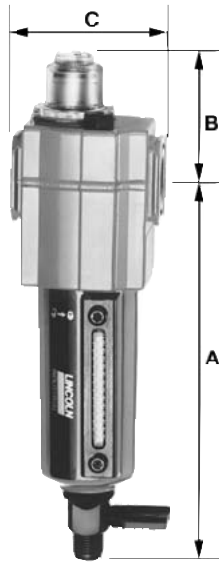

Modular Air Line Lubricators

Part No.	Maximum Air Supply	Operating Temperature Range	Material of Construction			Recommended Lubricants
			Body	Bowl	Sight feed Dome	
602204	250 psig 17 bar	0° to 150°F	Zinc	Zinc*	Transp Nylon	Misting type oil 50 to 200 SSU (ISO Grade 7 to 46) at 100°F (38°C)
602206		-18° to 65°C				
602208	0° to 175°F -18° to 79°C	Aluminum	Aluminum*			

* Transparent nylon liquid level indicator lens.

Part No.	Connections NPT-Female	Bowl Capacity ozs. / ml	Dimensions - in. / mm				Weight lbs. / kg
			A	B	C	D	
602204	¼	2.0	5.27	1.63	1.98	1.91	1.1
602206	⅜	58	134	41	50	48	0.5
602208	½	7.0 207	6.95 177	2.12 53	3.15 80	2.89 74	1.6 0.7

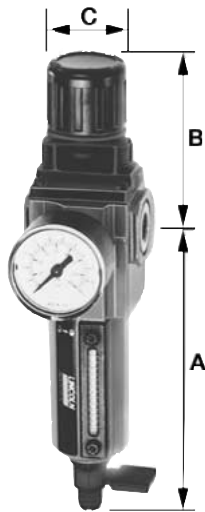

Integrated/Modular Filter/Regulator with Gauge

Can be used with other AirCare Modular Components.

Part No.	Maximum Air Supply	Operating Temperature Range	Element Particle Size	Outlet Pressure Adj. Range
602134	250 psig 17 bar	0° to 150°F	40µ	5 to 150 psig 0.3 to 10 bar
602136		-18° to 65°C		
602138		0.3° to 10°F -18° to 79°C		

Part No.	Drain Type	Port Size PTF	Dimensions - in. / mm				Weight lbs. / kg
			A	B	C	D	
602134	Manual	¼	5.27	2.89	1.98	3.29	1.2
602136		⅜	134	73	50	83	0.5
602138		½	6.95	4.98	3.15	5.10	2.6

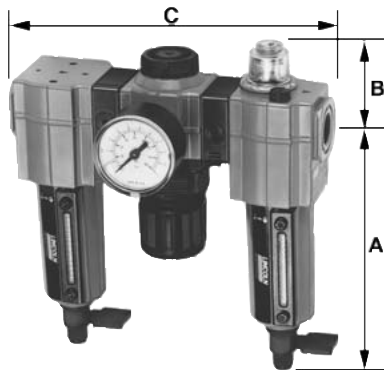

Modular Air Line Combination Units

Filter-Regulator with Gauge-Lubricator

Part No.	Maximum Air Supply	Operating Temperature Range	Element Particle Size	Outlet Pressure Adj. Range	Lubricator Bowl Capacity ozs. / ml
85387-4	250 psig 17 bar	0° to 150°F	40µ	5 to 150 psig 0.3 to 10 bar	2.0
85387-6		-18° to 65°C			58
85387-8		0° to 175°F / -18° to 79°C			7.0 / 207

* Transparent nylon liquid level indicator lens.

Part No.	Drain Type	Port Size PTF	Dimensions - in. / mm			Weight lbs. / kg
			A	B	C	
85387-4	Manual	¼	5.27	1.63	6.46	3.3
85387-6		⅜	134	41	164	1.5
85387-8		½	6.95 / 177	2.12 / 53	10.52 / 267	6.2 / 2.8

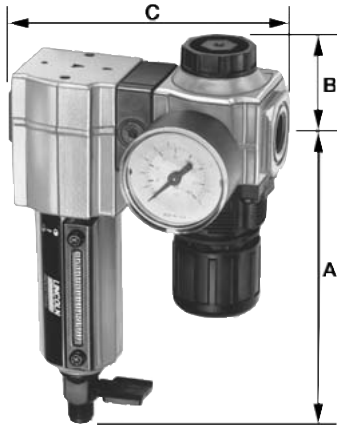

Modular Air Line Combination Units

Filter-Regulator with Gauge

Part No.	Maximum Air Supply	Operating Temperature Range	Element Particle Size	Outlet Pressure Adj. Range
85388-4	250 psig 17 bar	0° to 150°F	40μ	5 to 150 psig 0.3 to 10 bar
85388-6		-18° to 65°C		
85388-8		0° to 175°F / -18° to 79°C		

* Transparent nylon liquid level indicator lens.

Part No.	Drain Type	Port Size PTF	Dimensions - in. / mm			Weight lbs. / kg
			A	B	C	
85388-4	Manual	¼	5.27	1.31	4.22	2.1
85388-6		⅜	134	33	108	1.0
85388-8		½	6.95 / 177	1.69 / 43	6.84 / 174	4.2 / 2.0

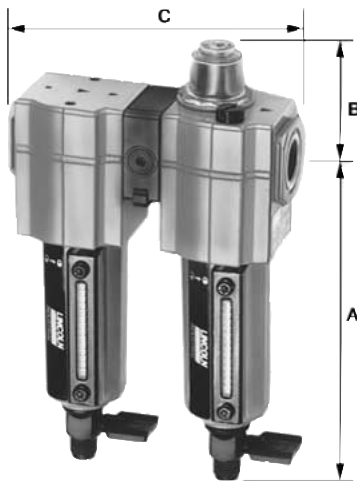

Modular Air Line Combination Units

Filter-Lubricator

Part No.	Maximum Air Supply	Operating Temperature Range	Element Particle Size	Lubricator Bowl Capacity ozs. / ml
85389-8	250 psig/17 bar	0° to 175°F / -18° to 79°C	40μ	7.0 / 207

* Transparent nylon liquid level indicator lens.

Part No.	Drain Type	Port Size PTF	Dimensions - in. / mm			Weight lbs. / kg
			A	B	C	
85389-8	Manual	½	6.95 / 177	2.12 / 53	6.84 / 174	3.8 / 1.7



High-Capacity Air Line Filters

Part No.	Maximum Air Supply	Operating Temperature Range	Material of Construction		Element	
			Body	Bowl	Material	Particle Size
602112	250 psig 17 bar	0° to 175°F -18° to 79°C	Aluminum	Aluminum* w/ Pyrex sight glass	Sintered bronze	50μ
602113						
602116						
602117						

* Pyrex liquid level indicator.

Part No.	Drain Type	Port Size PTF	Dimensions - in. / mm				Weight lbs. / kg
			A	B	C	Dia.	
602112	Manual	¾	10.44 / 265	1.25	4.75	5.52	4.1
602113	Automatic		10.06 / 256				
602116	Manual	1	10.44 / 265	32	121	140	1.9
602117	Automatic		10.06 / 256				

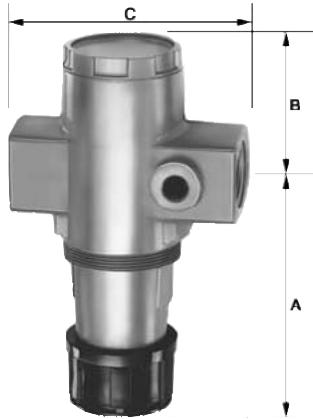

High-Capacity Air Line Regulators

Part No.	Maximum Air Supply	Operating Temperature Range	Material of Construction				Secondary (Gauge) Connections (in.)
			Body	Bonnet	Valve Seals	Bottom Plug	
602012	300 psig 20 bar	0° to 175°F -18° to 79°C	Aluminum	Aluminum	Aluminum Nitrile	Aluminum	¼ NPT (F)
602013							
602016							
602017							

Part No.	Outlet Press. Adj. Range psig / bar	Connections NPT-Female in.	Dimensions - in. / mm				Adjuster	Weight lbs. / kg
			A	B	C	D		
602012	10 to 250 / 0.7 to 16	¾	5.69 / 145	2.38	4.25	2.38	T-Handle	2.5
602013	5 to 150 / 0.3 to 10		4.71 / 120				Knob	
602016	10 to 250 / 0.7 to 16	1	5.69 / 145	60	108	60	T-Handle	
602017	5 to 150 / 0.3 to 10		4.71 / 120				Knob	

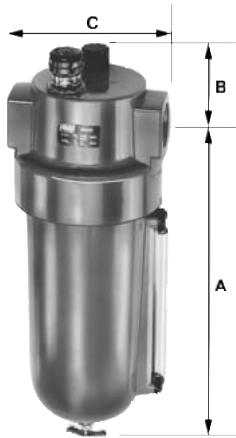

High-Capacity Air Line Lubricators

Part No.	Maximum Air Supply	Operating Temperature Range	Material of Construction			Recommended Lubricants
			Body	Bowl	Sight feed Dome	
602212	250 psig 17 bar	0° to 175°F -18° to 79°C	Aluminum	Aluminum*	Transp. Nylon	Misting type oil 50 to 200 SSU (ISO Grade 7 to 46) at 100°F (38°C)
602216						

* Pyrex liquid level indicator.

Part No.	Connections NPT-Female	Bowl Capacity ozs. / ml	Dimensions - in. / mm				Weight lbs. / kg
			A	B	C	Dia.	
602212	¾	32	10.24	2.22	4.50	5.52	3.6
602216	1	946	260	56	114	140	1.6

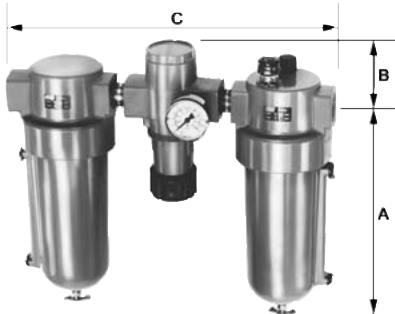

High-Capacity Air Line Combination Units

High-Capacity Filter-Regulator with Gauge-Lubricator

Part No.	Maximum Air Supply	Operating Temperature Range	Element Particle Size	Outlet Pressure Adj. Range	Lubricator Bowl Capacity ozs. / ml
85387-12	250 psig	0° to 175°F	50µ	5 to 125 psig	32
85387-16	17 bar	-18° to 79°C		0.3 to 8.6 bar	946

* Pyrex liquid level indicator.

Part No.	Drain Type	Port Size PTF	Dimensions - in. / mm			Weight lbs. / kg
			A	B	C	
85387-12	Manual	¾	10.44	2.22	14.75	10.6
85387-16		1	265	56	375	4.8

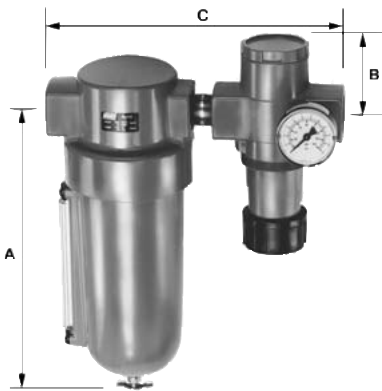

High-Capacity Air Line Combination Units

Filter-Regulator with Gauge

Part No.	Maximum Air Supply	Operating Temperature Range	Element Particle Size	Outlet Pressure Adj. Range
85388-12	250 psig 17 bar	0° to 175°F -18° to 79°C	50µ	5 to 125 psig 0.3 to 8.6 bar

* Pyrex liquid level indicator.

Part No.	Drain Type	Port Size PTF	Dimensions - in. / mm				Weight lbs. / kg
			A	B	C	Dia.	
85388-12	Manual	¾	10.44	2.38	10	5.52	6.9
			265	60	254	140	3.1



High-Capacity Air Line Combination Units

Filter-Lubricator

Part No.	Maximum Air Supply	Operating Temperature Range	Element Particle Size	Lubricator Bowl Capacity ozs. / ml
85389-12	250 psig 17 bar	0° to 175°F	50µ	32
85389-16		-18° to 79°C		946

* Pyrex liquid level indicator.

Part No.	Drain Type	Port Size PTF	Dimensions - in. / mm				Weight lbs. / kg
			A	B	C	Dia.	
85389-12	Manual	¾	10.44	2.22	10.25	5.52	7.8
85389-16		1	265	56	260	140	3.5



Miniature Air Line Components - Air Line Filter

Part No.	Maximum Air Supply	Operating Temperature Range	Material of Construction		Element	
			Body	Bowl	Material	Particle Size
602103	150 psig 10 bar	0° to 125°F -18° to 52°C	Zinc	Polycarbonate	Porous Polypropylene	50µ

Part No.	Drain Type	Port Size PTF	Dimensions - in. / mm				Weight lbs. / kg
			A	B	C	Dia.	
602103	Manual	¼	3.25 / 83	0.38 / 10	1.63 / 42	1.45 / 37	0.3 / 0.12

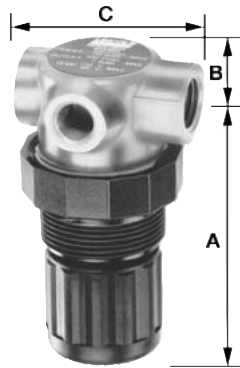

Miniature Air Line Components—Air Line Regulator

Part No.	Maximum Air Supply	Operating Temperature Range	Material of Construction				Secondary (Gauge) Connections-in.
			Body	Bonnet	Valve Seals	Bottom Plug	
602003	300 psig 20 bar	0° to 150°F -18° to 65°C	Zinc	Acetal	Brass/ Nitrile	Acetal	½ NPT (F)

Part No.	Outlet Pressure Adj. Range	Connections NPT-Female in.	Dimensions - in. / mm				Adjuster	Weight lbs. / kg
			A	B	C	D		
602003	5 to 100 psig 0.3 to 7 bar	¼	2.52 64	0.39 10	1.63 41	1.45 37	Knob	0.3 0.13



Miniature Air Line Components—Air Line Lubricator

Part No.	Maximum Air Supply	Operating Temperature Range	Material of Construction			Recommended Lubricants
			Body	Bowl	Sight feed Dome	
602203	150 psig 10 bar	0° to 125°F -18° to 52°C	Aluminum	Poly-carbonate	Transp. Nylon	Misting type oil 50 to 200 SSU (ISO Grade 7 to 46) at 100°F / 38°C

Part No.	Connections NPT-Female in.	Bowl Capacity ozs. / ml	Dimensions - in. / mm				Weight lbs. / kg
			A	B	C	Dia.	
602203	¼	1.0 / 30	3.25 / 83	1.98 / 50	1.63 / 41	1.45 / 37	0.3 / 0.13

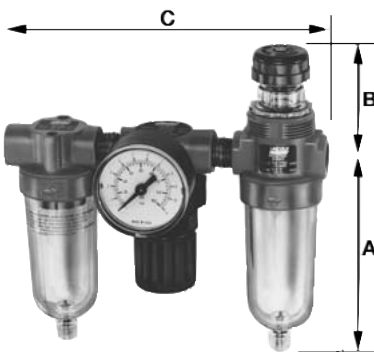

Miniature Air Line Combination Units

Filter-Regulator with Gauge-Lubricator

Part No.	Maximum Air Supply	Operating Temperature Range	Element Particle Size	Outlet Pressure Adj. Range psig / bar	Lubricator Bowl Capacity ozs. / ml
85672	150 psig / 10 bar	0° to 150°F / -18° to 65°C	50µ	5 to 100 / 0.3 to 6.9	1.0 / 30

Part No.	Drain Type	Port Size PTF	Dimensions - in. / mm				Weight lbs. / kg
			A	B	C	Dia.	
85672	Manual	¼	3.25 / 83	1.98 / 50	5.61 / 143	1.45 / 37	1.3 / 0.6



Miniature Air Line Combination Units

Filter-Lubricator

Part No.	Maximum Air Supply	Operating Temperature Range	Element Particle Size	Lubricator Bowl Capacity ozs. / ml
85674	150 psig / 10 bar	0° to 125°F / -18° to 52°C	5μ	1.0 / 30

Part No.	Drain Type	Port Size PTF	Dimensions - in. / mm				Weight lbs. / kg
			A	B	C	Dia.	
85674	Manual	¼	3.25 / 83	1.98 / 50	3.66 / 93	1.45 / 37	0.9 / 0.4

Modular Air Line Equipment Accessories— Lockout Valve

Install in-line or modular with other AirCare products to help conform to OSHA Lockout Regulations. In the closed position, valves block inlet air flow and exhaust downstream air.



Part No.	For Modular use with	For In-Line use with	Maximum Air Supply	Operating Temperature Range
247770	¼" Modular	¼"	250 psig 17 bar	0° to 150°F -20° to 65°C
247771	⅜" Modular	⅜"		
247772	½" Modular	½"		

Modular Air Line Equipment Accessories— Quick Clamp

Use with Modular Air Line Components to provide modular installation capability. Flanges on the products slide into "V" grooves in the quick clamp. Two face-sealing O-rings in the quick clamp provide an air tight connection when the clamp is closed.



Part No.	For Modular Sizes	Dimensions in. / mm
247782	¼" and ⅜"	1.50 / 38
247783	½" and ¾"	2.00 / 51

Modular Air Line Equipment Accessories— Quick Clamp Wall Mounting Bracket

Use with quick clamp to provide secure mounting to a wall, machine panel or other flat surface.

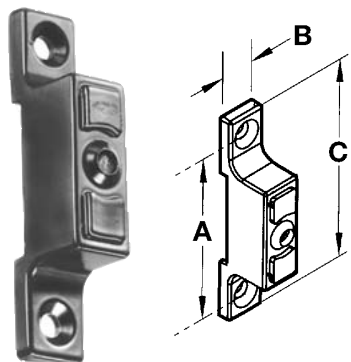

Part No.	For Modular Sizes	Dimensions in. / mm		
		A	B	C
247792	¼" and ⅜"	2.32 / 59	0.55 / 14	2.91 / 74
247793	½" and ¾"	3.25 / 83	0.95 / 24	4.0 / 102



Modular Air Line Equipment Accessories— Quick Mount Pipe Adapters

Use with quick clamp to provide threaded connections to the system piping.

Part No.	For Modular use with	Port Size - in.
247787	¼" and ⅜" Modular	⅜"
247789	½" and ¾" Modular	⅝"
247791		¾"

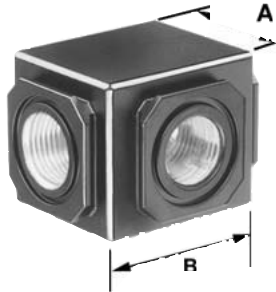

Modular Air Line Equipment Accessories— Manifold Block

Installs with quick clamps. Ports are threaded pipe to provide manifolding capability for up to three components.

Part No.	Port Size-in.	For Modular Sizes	Dimensions-in. / mm	
			A	B
247795	¾"	½" and ¾"	2.27 / 57.8	3.15 / 80



Modular Air Line Equipment Accessories— Pressure Switch

Monitors air pressure and provides an electrical signal when the pressure drops below or exceeds the preset pressure. Installs between two quick clamps. Also provides three additional ¼" auxiliary outlets.

Part No.	For Modular Sizes	Maximum Inlet Pressure	Operating Temperature Range	Adjustment Range
247796	¼" and ⅜"	250 psig 17 bar	0° to 150°F -20° to 65°C	30 to 150 2 to 10



Modular Air Line Equipment Accessories— Tamper Resistant Cover & Seal Wire

Install on the adjusting knob of regulators to help prevent unauthorized adjustment of the pressure setting.

Part No.	For Modular Sizes
247778	½" and ¾"

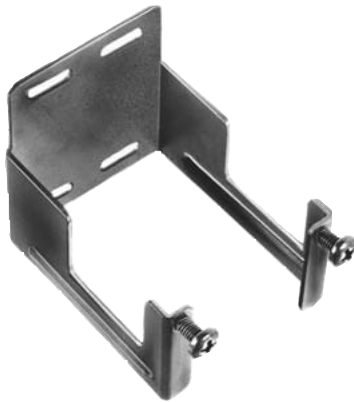

Modular Air Line Equipment Accessories— Wall Mount Bracket

Use to secure Modular Air Line components to a wall, machine panel or other flat surface.

Part No.	For Modular Sizes
247775	¼" and ⅜"
247776	½" and ¾"



Modular Air Line Equipment Accessories— Pressure Switch

Monitors air pressure and provides an electrical signal when the pressure drops below or exceeds the preset pressure. Installs between two quick clamps. Also provides three additional ¼" auxiliary outlets.

Part No.	For Modular Sizes	Maximum Inlet Pressure	Operating Temperature Range	Adjustment Range
247797	½" and ¾"	250 psig 17 bar	0° to 150°F -20° to 65°C	30 to 150 2 to 10



Air Line Equipment Accessories— Wall Mount Bracket—High-Capacity

Use to secure High-Capacity Air Line components to a wall, machine panel or other flat surface.

Part No.	Component
247799	All Filters and Lubricators



Air Line Equipment Accessories— Mounting Bracket and Nut—Miniature

Use to secure Miniature Air Line components to a wall, machine panel or other flat surface.

Part No.	Component
247774	All Regulators and Lubricators



Air Line Equipment Accessories— Pressure Gauges

Available in 1/8" NPT and 1/4" NPT back connection.

Part No.	For Regulator Sizes	Gauge Dia.	Connection	Pressure Range
247843	1/4" and 3/8"	1 1/2"	1/8" NPT	0 to 160 psig / 0 to 11bar
247844	1/2", 3/4" and 1"	2"	1/4" NPT	0 to 300 psig / 0 to 20 bar
247863				



Air Line Equipment Accessories— Cage Brackets

Heavy, steel mounting brackets for use with all standard size regulators. Affixes to regulator under cage screws.

Part No.	Pipe Size
69045	1/2"



Manual Shut-Off Valves—High-Pressure Needle Valves

For supply lines.

Part No.	Inlet/Outlet Female (in.) NPTF (F)	Dimension		Maximum Working Pressure
		A (Valve Open) in. / cm	B in. / cm	
778	¼	3¼ / 7.8	2½ / 6.4	10000 psig 680 bar
884	¾	3¾ / 9.5	2⅞ / 7.3	
885	½	3¾ / 9.5	2⅞ / 7.3	



Manual Shut-Off Valves—Quarter-Turn Valves

For supply lines.

Part No.	Connections NPTF-Female in.	Dimension - in. / cm		Maximum Working Pressure
		A	B	
69503	½	6½ / 15.3	1⅝ / 4.1	2000 psig 136 bar
69425	¾	6⅝ / 15.6	2⅞ / 7.3	
69423	1	7⅞ / 19.3	4¼ / 10.8	



Manual Shut-Off Valves—Low-Pressure Valve

Part No.	Inlet/Outlet in.	Maximum Working Pressure
68042	⅝ NPTF (F) x ⅝ NPTF (M)	150 psig / 10 bar



Manual Shut-Off Valves—Low-Pressure Quarter-Turn Valves

Part No.	Inlet/Outlet NPTF (F) in.	Maximum Working Pressure
66084	½	710 psig / 48 bar
70332	¾	600 psig / 41 bar
256200	¼	300 psig / 20 bar



Pressure Gauges—High-Pressure Gauges

For lubricant supply lines.

Part No.	Maximum Register	Indicator Needle	Dial Diameter in. / mm	Connection	
				Size in.	Location
66689	2000 psig	Single	2½	¼ NPT(M)	Bottom
68946	140 kg/cm²	Dual			
69844	3000 psig	Single	65		Back Center
69827	210 kg/cm²				
66111	5000 psig / 350 kg/cm²	Single	3½ / 88.9	Bottom	
69039	5000 psig 350 kg/cm²	Dual	2½ / 65		



Pressure Gauges—Low-Pressure Gauges

For air lines.

Part No.	Maximum Register	Indicator Needle	Dial Diameter in.	Connection	
				Size in.	Location
66100	200 psig	Single	2	¼ NPT(M)	Bottom
600401	14 kg/cm ²				Back Center

Lubricant Filters

Remove solid contaminants before delivering lubricants to the supply line. Filters mount in pump outlet before vent valve on reciprocating pump systems.



Part No.	Element Size micron	Maximum Pressure	Connections in.	Hex Body Size - in.
84004	140	5000 psig / 340 bar	½ NPTF (M)	¼
84528	420			
*84239	10	6000 psig / 408 bar	¼ NPTF (F)	1¼

* In-line filter with Viton® seal.

Lubricant Strainers

Remove solid contaminants before delivering lubricants to the supply line. Strainers mount at pump inlet.

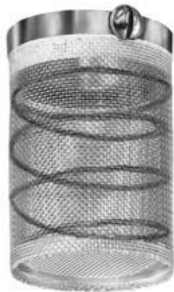

Part No.	Use with Pump/Model Type	Strainer Size
82103	Series 20 Models 1823/282288	500 Micron

Note: Not recommended for use with heavy lubricants.